



NEW VIEW OF BLUE 7800 SERIES 4-LINE LCD DISPLAY

MARK LAMPE
PRODUCT MARKETING MANAGER

September 12th

Honeywell

S7800A2142 4-LINE LCD

The newest and best way to interact with any 7800 Series Flame Relay module.



New Display. New Possibilities.

SIMPLE NAVIGATION

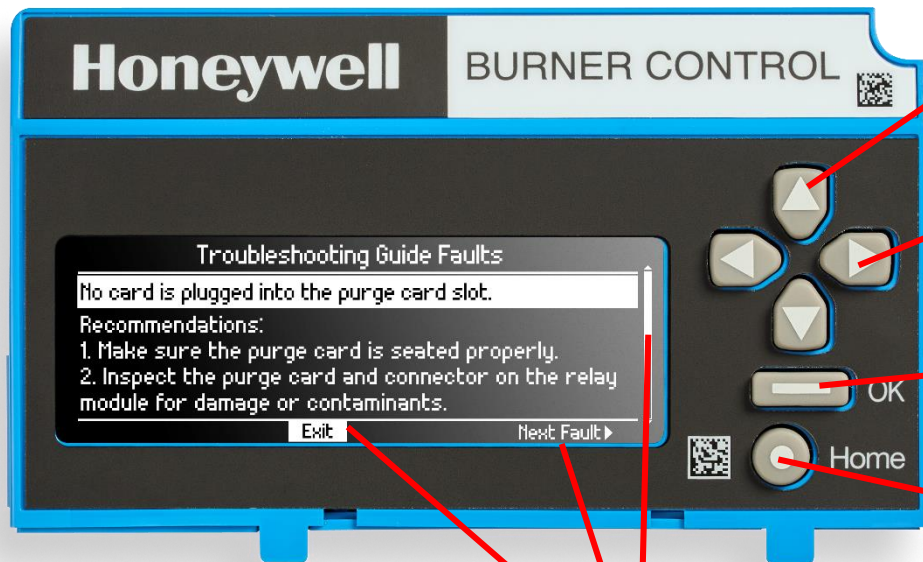

Up/Down scroll buttons- indicates on the screen when there is more content available

Left/Right buttons- moves from one menu to the next - indicates on the screen when there is more content available

OK button- confirms that you want to make the changes noted on the screen

Home button - no matter where in the menu structure can go to home screen any time

Navigation Prompts:

- Highlighted action
- More data to view
- Scroll bar- up/down

Display prompts guide you through the menus

EASY INSTALLATION

- **Compatible with all installed and new Honeywell 7800 SERIES systems**
 - Simply remove existing cover or 2-line display and replace with the 4-line LCD... It is that simple*
- **Includes 3 different languages options in one display**
 - English, Spanish, French
- **Programming of the display**
 - Mounted on a 7800 SERIES Relay Module
 - Via 13 VDC power source connected to the KDM through the 203541 5-wire connector
- **Home page, sleep, inactivity settings**
 - Selected home page status- fully customizable
 - None, 30 seconds, 1/5/30/60 minutes

* programming required



One display replaces three different sku's

LARGER AND EASIER TO READ

- **Five-row by 64-column hi-contrast back-lit display**
 - Home and Lock-out pages uses larger fonts to be able to see from a distance
 - Backlight level adjustment
- **Front panel mounting options**
 - Optional NEMA4 covers with and without remote reset
- **View real-time system run status**
- **Real time troubleshooting guide based on specific error codes**
 - Offers suggestions on ways to fix the lock-out in plain, easy to read language

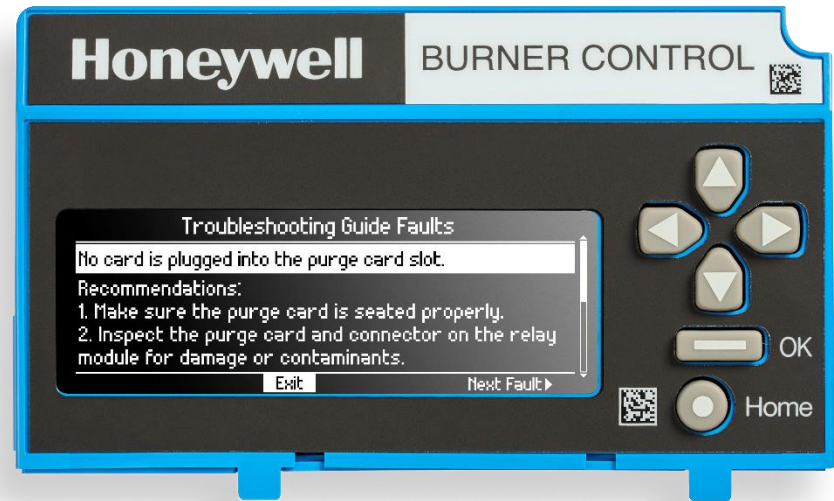

Real-time system run status

INTUITIVE MENU

Easily access important information right from the home page.

- Sequence or lockout state
 - Lockout message
 - Fault history
 - Diagnostic status
- Flame signal strength
- Total cycles count
- Total run-time hours count
- Annunciator connection status
- Remote command status
- Valve Proving
- Post purge

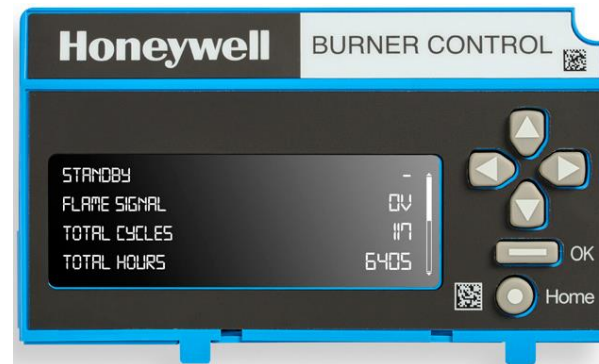

▲
SCROLL
UP/DOWN
TO SEE
ALL MAIN
MENU
OPTIONS
▼

Key Features Available

TECHNICAL ADVANCEMENTS

- **Call Service Business Card**

- Program a 6-line personal lockout message using upper and lowercase letters, numbers and symbols
- Can be displayed along with the standard lockout display message.
- Gives customers immediate contact information in the event of a lock-out or service issue.
- Can be set up ahead of time without being connected to a 7800 SERIES device.

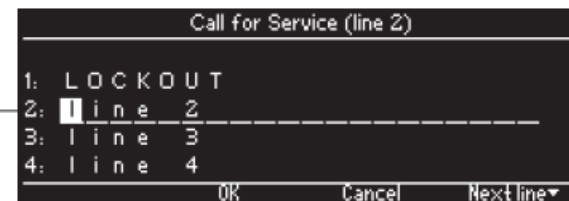
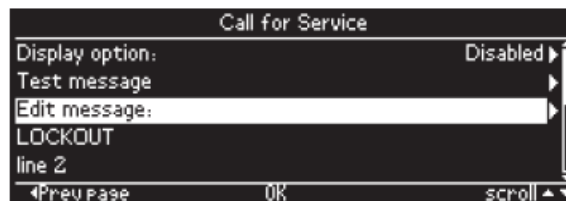
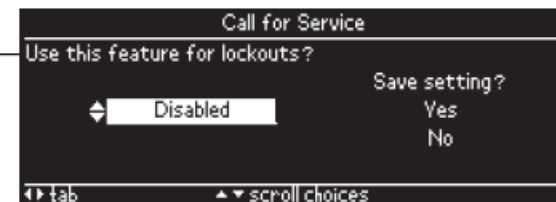
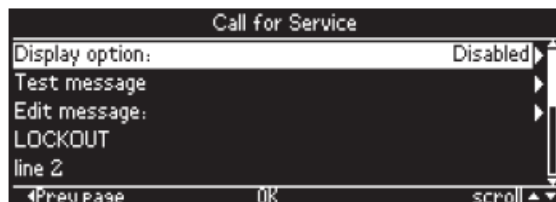

Key Features Available

TECHNICAL ADVANCEMENTS

- **Expanded Annunciator** (when used)
 - Allows for naming the S7830 Expanded Annunciator terminals to match your system's drawings
 - Display will annunciate the lockout both code letter and description
 - Message is pass code protected feature
- **Modbus communication feature**
 - Baud rate, parity, Endian order
- **BC Commissioning**
 - Will display only if burner control has this capability- will flash to indicate set-up is required.
 - Valve Proving – define at what point testing occurs
 - Post-Purge Timing – set to 0-60 seconds or 0-63 minutes

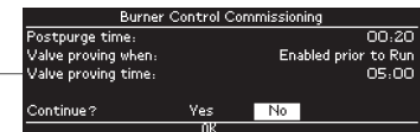
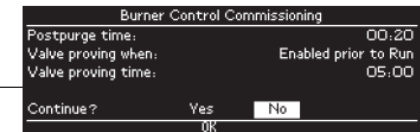
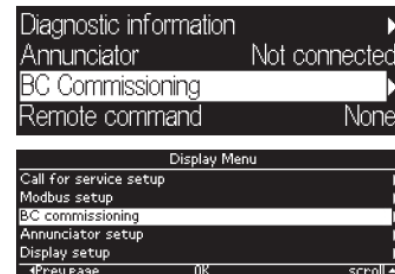

Key Features Available

FAULT HISTORY

- **82 different sequence state codes**
- **223 string codes**
- **127 fault code messages**
- **Tracks six of the most recent faults**
 - Cycles of operation at time of fault
 - Fault message and code at time of fault
 - Hours of operation at time of fault
 - Sequent time and status at time of fault
- **Diagnostics Information**
 - Device, flame amp type
 - Flame failure response time (FFRT)
 - On-Off status of all digital inputs and outputs
 - Status of configuration jumpers
 - Status of run/test switch
 - Reset count and reason



Immediate feedback on status of the system – optimal up-time

PERFORMANCE SPECIFICATIONS

Electrical Ratings

- Voltage and Frequency: 13 Vdc peak full wave rectified (+20%/-15%).
- Power Dissipation: 7W maximum.
- VA consumption: 2 VA maximum.

Terminal Ratings

- Power: 13 Vdc peak full wave rectified. Earth Ground

Environmental Ratings

- Ambient Temperature Ranges
 - Operating: 0°F (-18°C) to +140°F (+60°C)
 - **Important note: current 2-line VFD low temp range 140°F (-40°C)**
 - Storage: -22°F (-30°C) to +158°F +70°C).
- Humidity: 85% relative humidity continuous, noncondensing.
- UL NEMA Class 4 rating when P/N 204729A/C NEMA 4 cover is used.



Rugged Design, Widespread Applications

APPROVALS

- **Underwriters Laboratories Inc.**
 - Listed: File No. MP268, guide No. MCCZ.
- **Factory Mutual Approved**
 - Report No. J.I.1V9A0.AF.
 - Federal Communications Commission
 - Part 15, Class B emissions.
- **EN60730**
 - Compliance with remote KDM mounting requirements
 - Provide electrical insulation separation by insulation using double or reinforced insulation.



Global Approval

OPTIONAL ACCESSORIES

- ControlBus 5- wire connector 203541/U
- Data ControlBus Module S7810A1009/U
- Remote display mounting bracket 203765/U
- Extension cable assembly- 60"/120" 221818A/221818C
- NEMA4 cover w/reset 294729C/U
- NEMA4 cover w/o reset 294729A/U
- Remote display flush mount kit 205321B/U



Size and fit the same! Need new NEMA4 covers

LAUNCH PROMOTION

- **For eligible distribution customers**
 - Creates awareness of a new tool that offers better insight into system performance
 - Every service personnel should have this on their truck!
- **Buy 10 S7800A2142 KDM's and receive the counter-top demo unit free**
 - One display per retail location
- **Promotion runs Sept 1 – Dec 31**
 - Simply fill out promotion redemption form, send it in and receive a display* unit
- **Sales tools**
 - Details on all sales training and collateral available
 - Website, sell sheet, training module, sales video

*Limited functionality in counter display unit



A New View of Blue – shipping mid September '19

LINKS TO ADDITIONAL INFORMATION

7800 Series 4-Line LCD Website

7800 Series 4-Line LCD Brochure

Video (YouTube)

Additional Resources